

- Tested to ANSI/UL10B, ANSI/UL10C by Underwriters Laboratories Inc.
- Tested to EI 60 (GOST 30247.2-97) by Center of Certification and Test "OGNESTOYKOST-CNIISK"
- Tested to EN 1634-1:2009 in process



Steel Fire Doors to Multinational Standard

Single and double-leaf doors in matching appearance
with additional protection features

General information

When a fire starts, it is most important to evacuate the people safely from the building. After evacuation, the doors must serve as a fire and smoke barrier. It is a well-known fact, that in a fire more people are killed by either smoke asphyxiation or by panic, than by the fire.

Fire Doors must serve four main function:

- Serve as a regular door at all times.
- Provide ready egress from a fire area during a fire.
- Inhibit the fire from spreading throughout the building or to adjacent building.
- Protect life and property by reducing smoke hazards.

FIRE PROTECTION BECAUSE IT'S GOOD TO BE ON THE SAFE SIDE

In-house product development



Reliable fire protection calls for adequate new developments and improvements in each and every detail. This is where our qualified development teams demonstrate their competence time and again. Zhucheng has continually extended its fire protection programme. Today, as a result, we can offer a complete and fully developed range.

Pre-tested in Zhucheng's own fire house



In our own lab's fire house, highly sensitive instruments precisely measure the thermal load. In this way, new developments can be tested at every stage and optimum conditions created for external testing and the granting of official approvals.

200,000 times in the fatigue test



Alongside heat resistance, mechanical serviceability is an essential constituent of the extensive material testing carried out. This ensures that over many years in daily use Zhucheng doors will always function to perfection.

Flexible manufacturing production line



Zhucheng invests in modern production technology in highly-specialized factories. Computer-controlled processing guarantees precision cutting, punching, bending and the perfect fit of all hardware and functional components. This is the prerequisite for customized solutions in the overseas building projects.

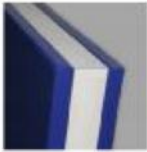

Standard specification

<p>Certificate</p> <ul style="list-style-type: none"> American standard UL (ANSI/10B, ANSI/10C) Russian standard EI60 (GOST 30247.2-97) European standard EN 1634-1:2009 	<p>Standard color</p> <table border="0"> <tr> <td></td> <td></td> <td></td> </tr> <tr> <td></td> <td></td> <td></td> </tr> <tr> <td></td> <td></td> <td></td> </tr> <tr> <td></td> <td></td> <td></td> </tr> <tr> <td></td> <td></td> <td></td> </tr> </table>															
<p>Fire rating</p> <ul style="list-style-type: none"> 20 minutes, 30 minutes, 45 minutes, 60 minutes, 90 minutes, 120 minutes 	<p>Special color</p> <ul style="list-style-type: none"> Acceptable, in chosen other RAL color 															
<p>Door leaf</p> <ul style="list-style-type: none"> 52mm thick Sheet thickness 1.0mm Thermal insulation: ceramic fiber board All-round fire and smoke prevention expansion seal (on 4 sides) 	<p>Hinges</p> <ul style="list-style-type: none"> 4.5"×4.5"×3.4mm stainless steel hinge w/2 ball bearings American-style heavy-duty stainless steel hinge (optional) 															
<p>Frame</p> <ul style="list-style-type: none"> Double rabbet frame with all-round fire and smoke prevention expansion seal Sheet thickness 1.5mm Welded-on anchor brackets (standard) 	<p>Lock</p> <ul style="list-style-type: none"> Panic bar exit device with lever handle Fire-resistant mortise lock with profile cylinder & keys with lever handle (optional) 															
<p>Floor details</p> <ul style="list-style-type: none"> With stepped threshold With demountable threshold (optional) 	<p>Closing devices</p> <ul style="list-style-type: none"> Overhead door closer 															
<p>Surface finish</p> <ul style="list-style-type: none"> Door leaf and frame powder coated in RAL color 	<p>Accessories</p> <ul style="list-style-type: none"> Expansion bolts & plastic covers for installation use 															

Steel Fire Door

Ideal for Domestic, Industrial & Commercial buildings, Basement, Storage, Agriculture, Fire sections, Fire walls



FD 00



FD 03H-1

Steel Fire Door

Ideal for Domestic, Industrial & Commercial buildings, Basement, Storage, Agriculture, Fire sections, Fire walls



FD 02



FD 03

Steel Fire Door

Ideal for Domestic, Industrial & Commercial buildings, Basement, Storage, Agriculture, Fire sections, Fire walls



FD 03



FD 01

Steel Fire Door

Dimensions and Technical Details

STANDARD EI 60 (GOST 30247.2-97)

APPROVED BY CENTER OF CERTIFICATION AND TEST "OGNESTOYKOST-CNIISK"

Standard Sizes

Type	Ordering size width×height	Clear passage width×height	
		stepped threshold	demountable threshold
Single-leaf	800×2000	681×1893	681×1940
	900×2000	781×1893	781×1940
	1000×2000	881×1893	881×1940
	800×2100	681×1993	681×2040
	900×2100	781×1993	781×2040
	1000×2100	881×1993	881×2040
	1100×2100	981×1993	981×2040
Double-leaf	1200×2100	1081×1993	1081×2040
	1300×2100	1181×1993	1181×2040
	1400×2100	1281×1993	1281×2040
	1500×2100	1381×1993	1381×2040
	1600×2100	1481×1993	1481×2040
1800×2100	1681×1993	1681×2040	

Special Sizes

Type	Ordering size width×height	
Single-leaf	Min.	735×1470
	Max.	1155×2310
Double-leaf	Min.	1190×1470
	Max.	1870×2310

Standard glazing

Type	Glazing size width×height
Single-leaf & Double-leaf	120×630
	150×720
Double-leaf	390×630
	∅ 336

Special Glazing

The Sum of the exposed glazing area should not exceed 25% of the door area.

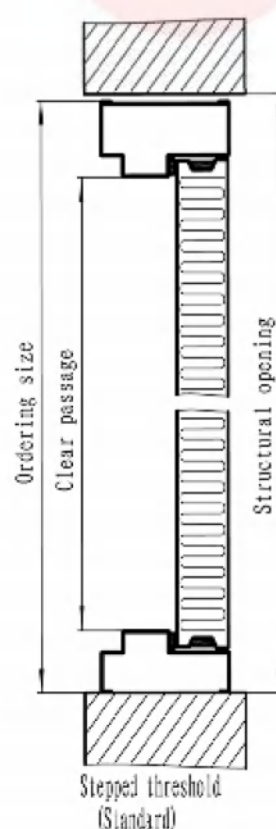
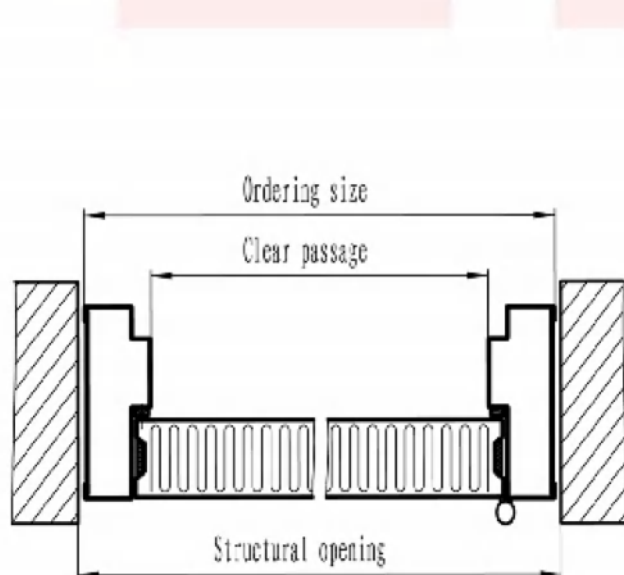

Standard Sizes

Type	Ordering size width×height	Clear passage width×height	
		stepped threshold	demountable threshold
Single-leaf	800×2100	681×1993	681×2040
	900×2100	781×1993	781×2040
	1000×2100	881×1993	881×2040
	955×2084	836×1977	836×2024 (panel 2'10"× 6'8")
	955×2186	836×2079	836×2126 (panel 2'10"× 7')
	1005×2084	886×1977	886×2024 (panel 3'× 6'8")
	1005×2186	886×2079	886×2126 (panel 3'× 7')
	955×2112	836×2005 (panel 2'10"× 6'8")	836×2052
	955×2214	836×2107 (panel 2'10"× 7')	836×2154
	1005×2112	886×2005 (panel 3'× 6'8")	886×2052
	1005×2214	886×2107 (panel 3'× 7')	886×2154
Double-leaf	1200×2100	1081×1993	1081×2040
	1300×2100	1181×1993	1181×2040
	1400×2100	1281×1993	1281×2040
	1500×2100	1381×1993	1381×2040
	1924×2084	1805×1977	1805×2024 (panel 6'× 6'8")
	1924×2186	1805×2079	1805×2126 (panel 6'× 7')
	1924×2112	1805×2005 (panel 6'× 6'8")	1805×2052
	1924×2214	1805×2107 (panel 6'× 7')	1805×2154

Standard glazing

Type	Glazing size width×height
Single-leaf & Double-leaf	120×630
	150×580

Special Glazing

The sum of the exposed glazing area should not exceed 96 square inch per door, and the width and height should not exceed 12 and 33 inch respectively. Accordingly, the width and height of real glazing should not exceed 340 and 860 mm respectively.

MEETING EDGE DETAILS

All Zhucheng double-leaf fire doors are assembled with double Astragal.

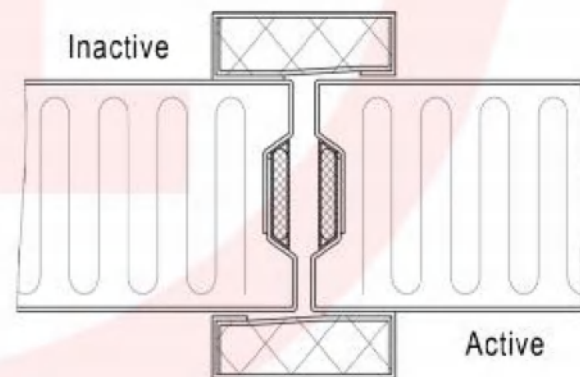

With double Astragal (standard)

Special Sizes

Type	Ordering size width×height	
Single-leaf	Max.	1043-3.0×2300-2.0
Double-leaf	Max.	2000-3.0×2300-2.0

HANDING

To determine the hand of a door, view the door from the outside.

- If the door swings to the viewer, the door is defined as "swing out".
- If the door swings away from the viewer, the door is defined as "swing in".

All Doors are handed according to the following chart:

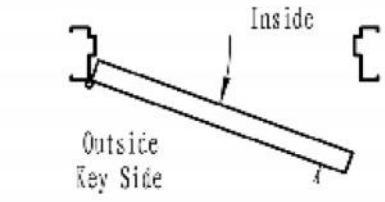
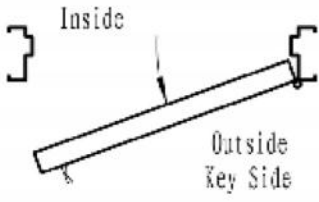
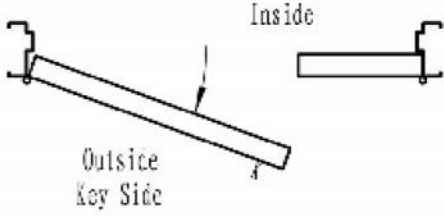
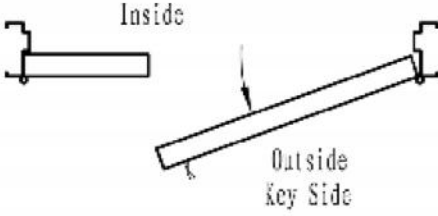
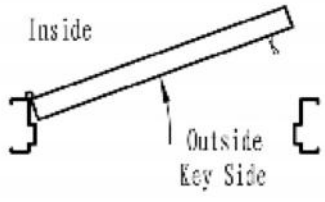
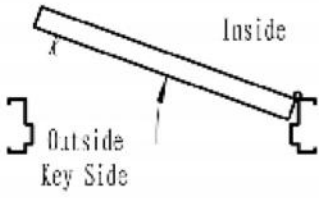
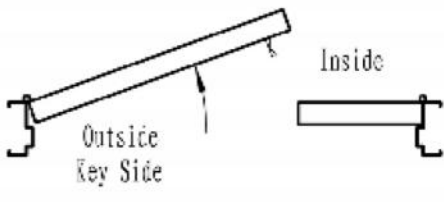
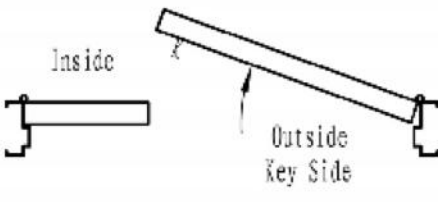
<p>Left Hand (Swing Out)=L/O</p> 	<p>Right Hand (Swing Out)=R/O</p> 
<p>Left Hand (Swing Out)=L/O</p> 	<p>Right Hand (Swing Out)=R/O</p> 
<p>Left Hand (Swing In)=L/I</p> 	<p>Right Hand (Swing In)=R/I</p> 
<p>Left Hand (Swing In)=L/I</p> 	<p>Right Hand (Swing In)=R/I</p> 

K - indicates Key side of the active door

TYPICAL MODELS

Purchase Zhucheng fire doors and you are assured quality, protection and safety for decades. Take advantage of our comprehensive range to meet the special requirements of your application.

Please choice the following typical models when you order:



FD 00



FD 00H

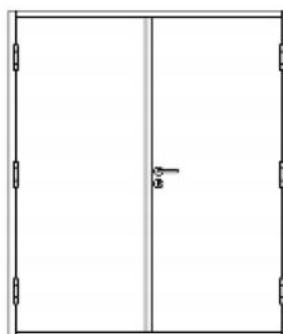

FD 00D



FD 01



FD 01H

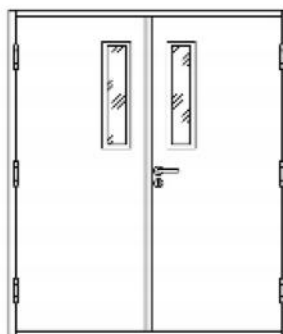

FD 01D



FD 02



FD 02H

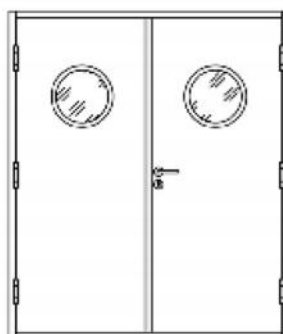

FD 02D

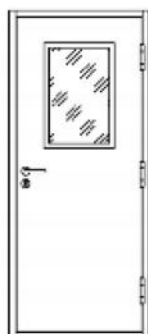

FD 03

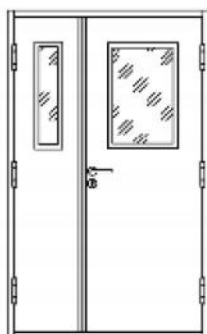

FD 03H-1

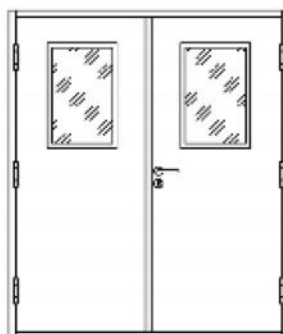

FD 03D

PRODUCTION EQUIPMENT



Salvagnini S4
Punching and shearing system



Salvagnini P4
Automatic panel bending system



Automatic coating line



Automatic cut to length line

QUALITY SYSTEM CERTIFICATE



ISO 9001:2000 Quality System Certificate

STEEL FIRE DOOR CERTIFICATE



UL certificate of fire door frames



UL certificate of fire doors

STEEL FIRE DOOR CERTIFICATE



Russian EI60 (single door) certificate



Russian EI60 (double door) certificate

HARDWARE DETAILS



Fire-resistant mortise lock with profile cylinder & keys with lever handle



External lever handle of panic bar exit device



Internal push bar of panic bar exit device



American-style heavy-duty stainless steel hinge



Keyhole plate



Overhead door closer



4.5" x 4.5" x 3.4mm stainless steel hinge



Flush bolt



Glass light frame (No screws assembly patent)



Overhead door closer

FRAME TYPES AND FITTING SITUATIONS

Frame type

Fitting situation

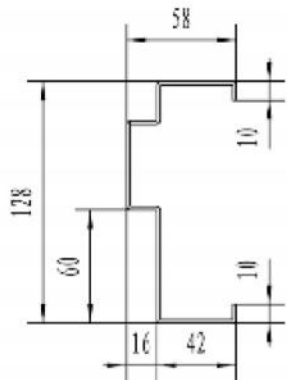

F128 Flat Frame

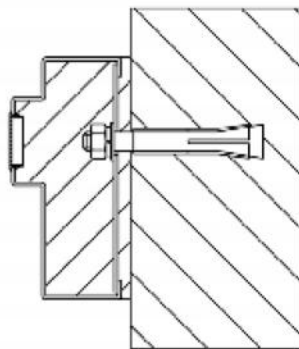

Fitting into Masonry/
Concrete/Brick wall
with Expansion bolts

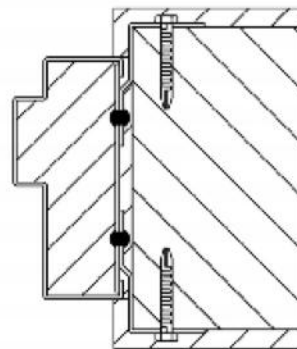

Fitting into Masonry/
Concrete/Brick wall
with Expansion nails

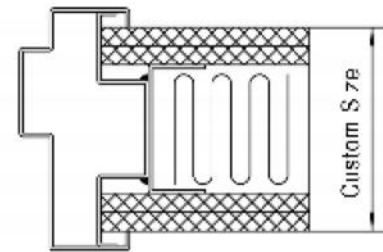

Fitting into Light-weight
walls/Partition walling
With Welding method

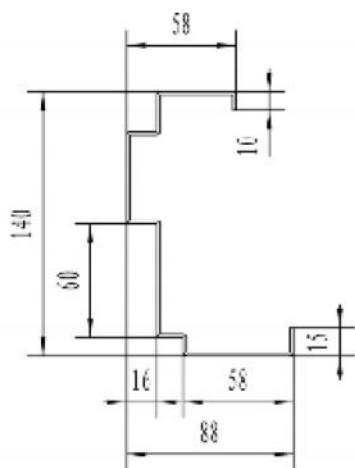

S140 Surround Frame

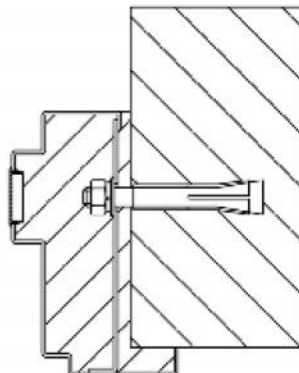

Fitting into Masonry/
Concrete/Brick wall
with Expansion bolts

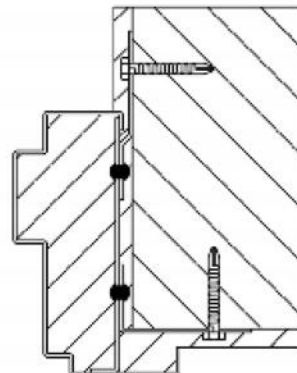

Fitting into Masonry/
Concrete/Brick wall
with Expansion nails

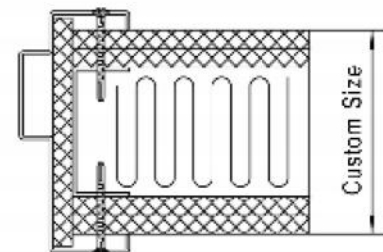

Fitting into Light-weight
walls/Partition walling
With Screws

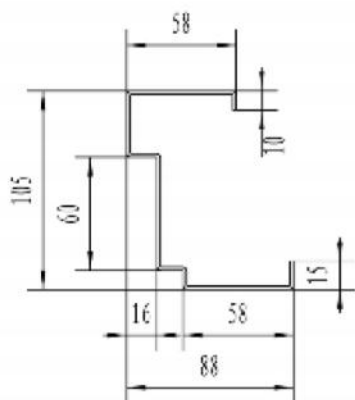

S105 Surround Frame

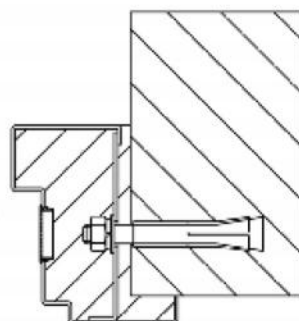

Fitting into Masonry/
Concrete/Brick wall
with Expansion bolts

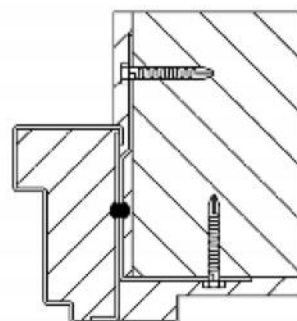

Fitting into Masonry/
Concrete/Brick wall
with Expansion nails

Good products without Borders

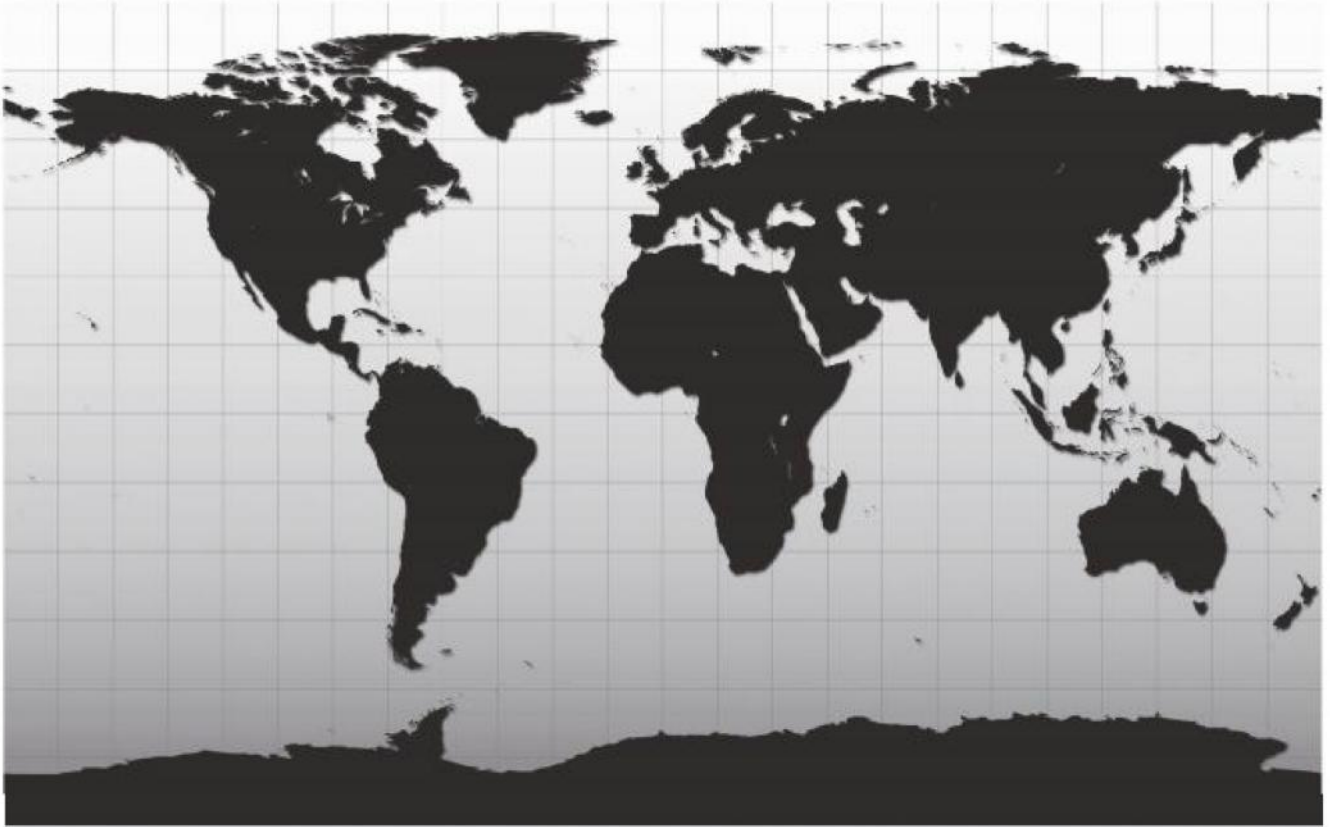

Our company is the only manufacturer worldwide that offers you a complete range of all major building products .

we manufacture in highly-specialized factory using the newest production technologies.

Sales and service companies throughout North America, South America, Europe, and a network of events in Asia, Africa and Oceania make us a strong partner for your first-class construction products, offering "good products without borders".

SECURITY DOORS

COMMERCIAL DOORS

INTERIOR DOORS

HOSPITAL DOORS

GLASS DOORS