



DONG WEI
东维元宇（廊坊）国际贸易有限公司

Dongwei Yuanyu (Langfang) International Trade Co., Ltd.

Container House

Option 1—Flatpack Container



6055*2438*2896mm

5990*2435*2800mm



Option 2— Prefab Container



5900*2250*2500mm



Advantages

1. About 50% less cost than prefab house
2. Five workers can finish a container installation in 4 hours.
3. Integrated floor system and roof system
4. 360-degree seaming and 3-5% slope for the roof
5. Bolt connection makes assembly and disassembly more convenient.
6. Mainly used for : worker's dormitory, temporary hospital, shop, hotel etc



Container House— Structure



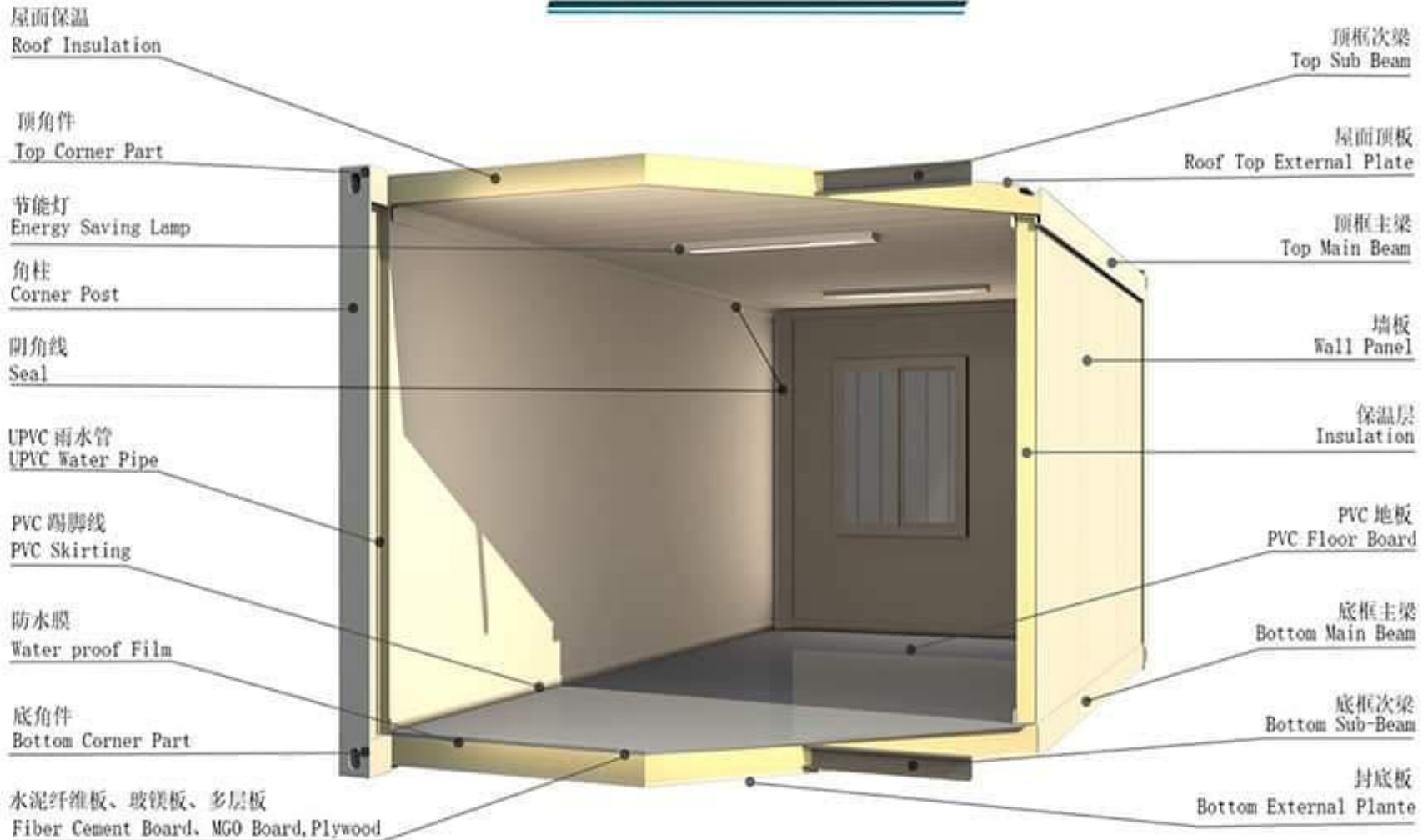

产品结构 Product Structure

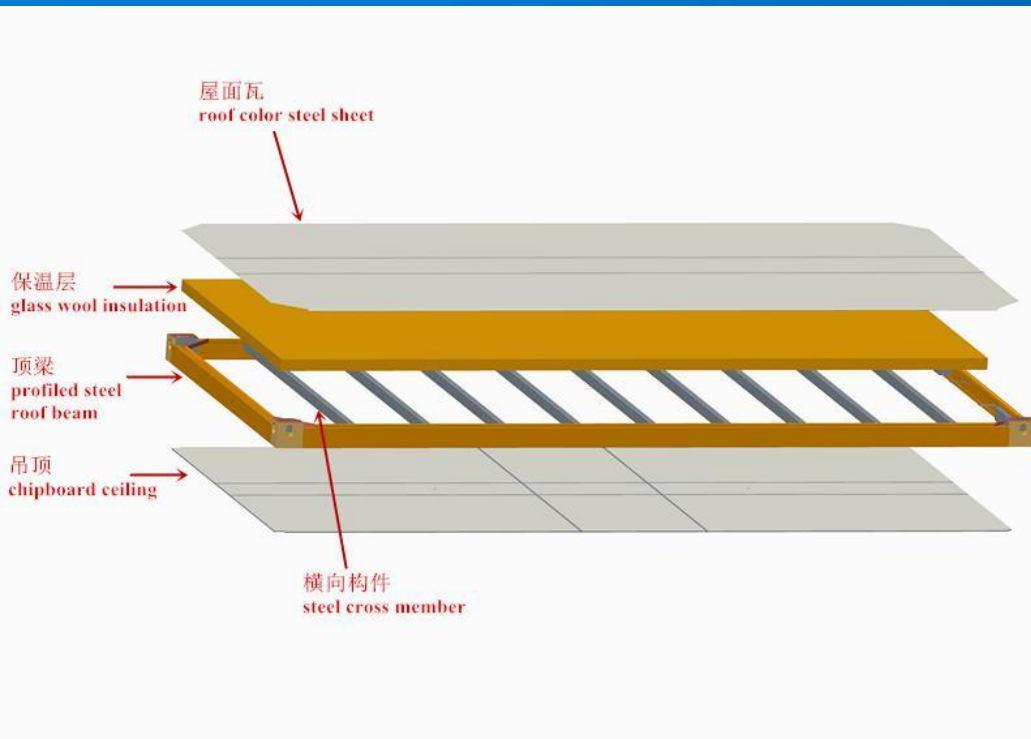

Container House—Roof System





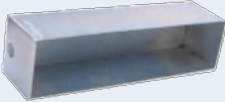

Container House—Roof Materials

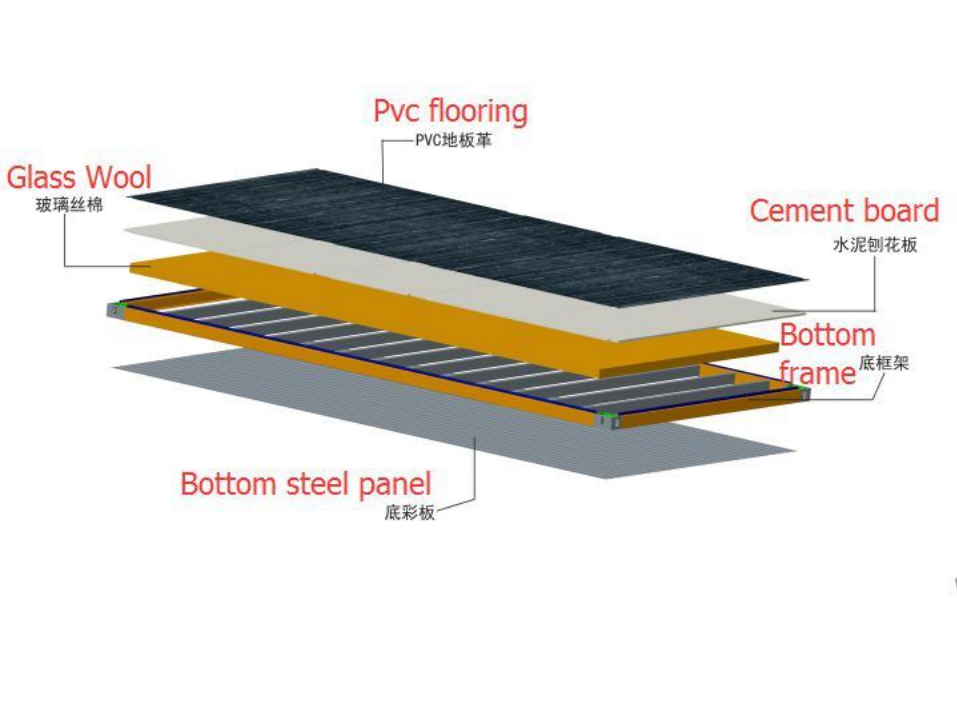
Accessories	Top corner	Beam	C type structure	Heat insulation	Electric Box
Material/ Technology	Milling Machine Milling flat	Steel material	Steel material	Glass wool	Steel material
Specification	210×150×200 mm	3mm	2mm	100mm	105×100×395 mm
Surface Treatment	Galvanize	Galvanize	Galvanize		Galvanize
Component Picture					

Container House—Floor System

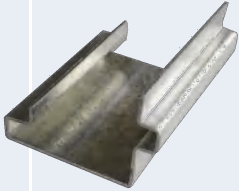

Container House—Floor Materials

Accessories	Top corner	Bottom beam	C type structure	PVC flooring	Water pipe	Drain tank
Material/ Technology	Milling Machine Milling flat	Steel Material		PVC flooring	Stamping parts	Color plate punching
Specification	210×150×200 mm	4mm thickness	2mm thickness	1.8mm		0.8mm
Surface Treatment	Galvanize	Galvanize	Galvanize			Galvanize
Component Picture						

Container House--Wall Panel

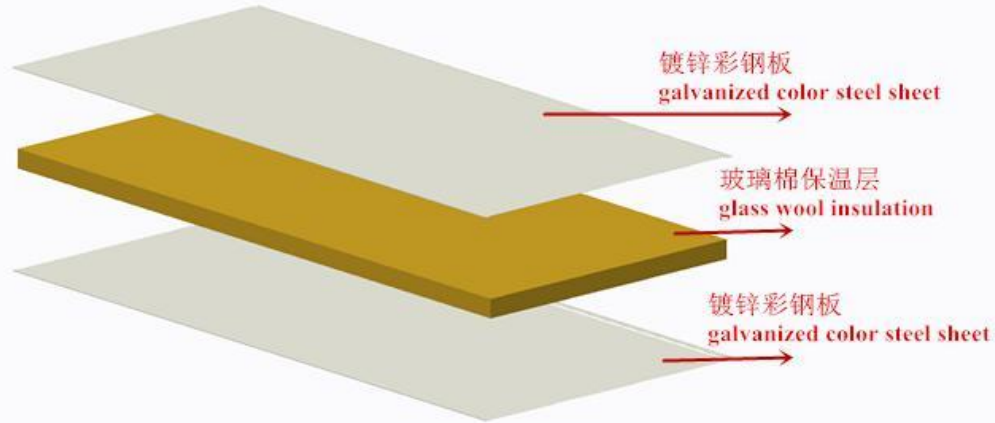

Wall Panel Spec.

Regular : 1: 50mm T

2: 75mm T

Non-regular : 100mm T

150mm T



Container House--Window and Door



Door
940*2035mm



Window
1100*930mm

Container House- Standard Container+ Decoration



Container House- Loading

Land
Transportation



Container House- Loading

Shipping

40HQ=6 Units



Container House-Profiled Steel Beam Production



Galvanized Steel frame

formed at one time by automatic machine.

Container House- gutter and roof seaming



The gutter and top beam are formed at one time.

360-degree seaming and 3-5% slope for the roof

One downpipe in each corner.

Container House-Assembling



Container House-Disassembling

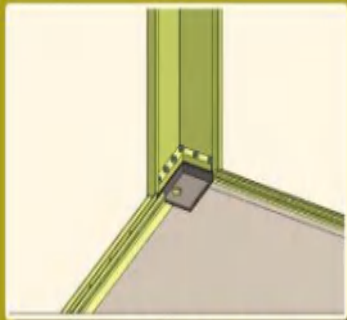

立柱与底梁连接 The Corner post jointed with the bottom beam

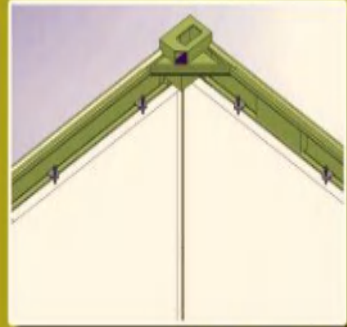

墙板的固定 Install method of wall panel



立柱与顶梁连接 The Corner post jointed with the top beam



Bolt connection makes the assembling and disassembling much easier.



Container House-Interior Decoration



Design-1

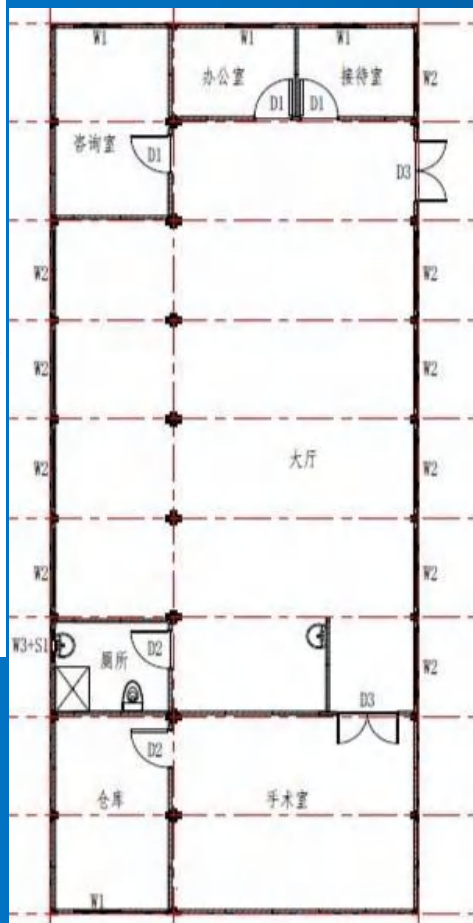

Design-2

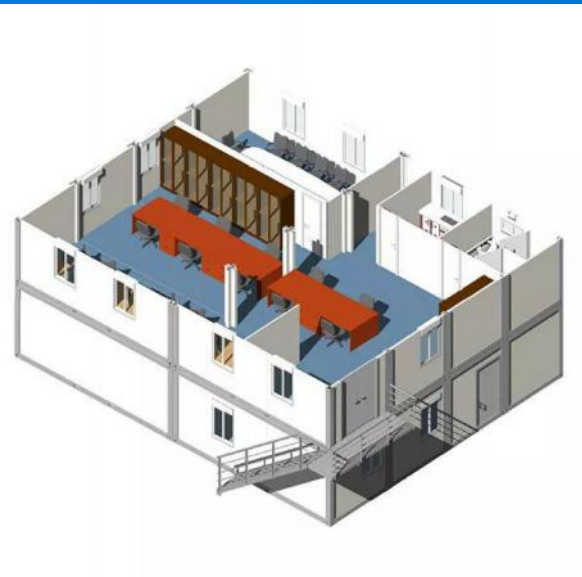

Design-3

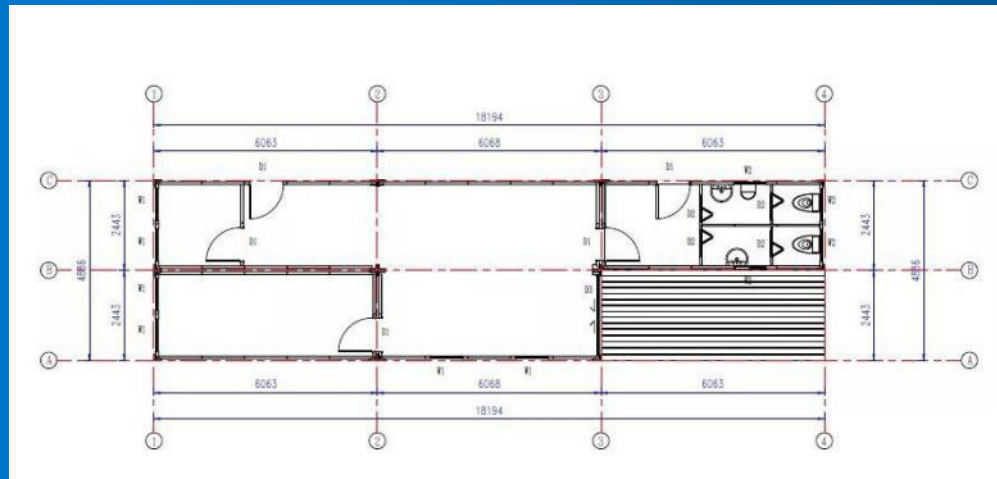
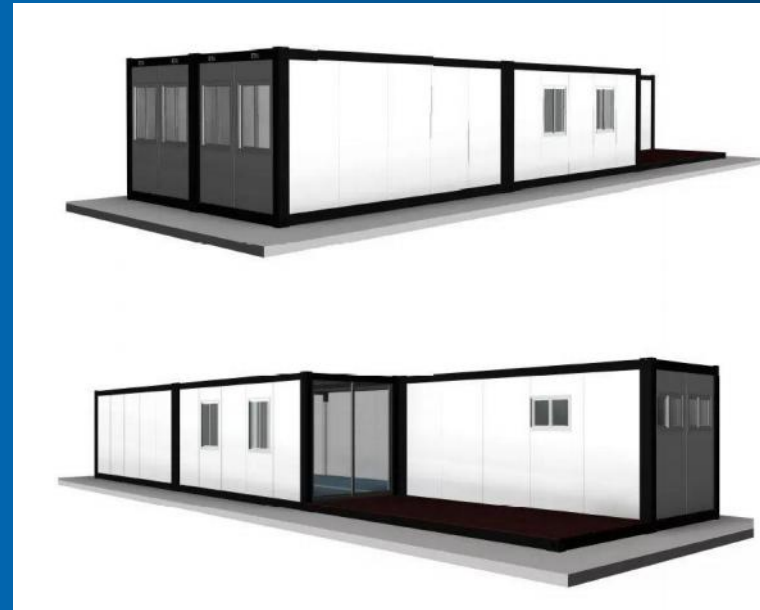
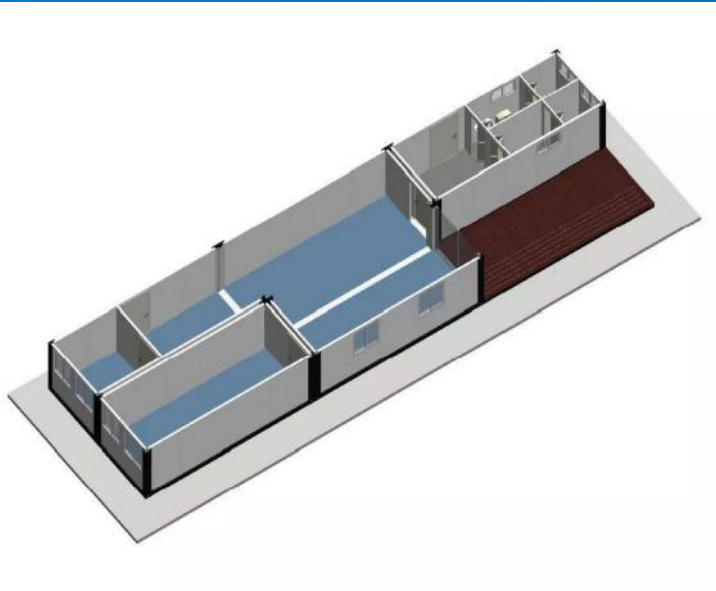

Project-Workers' Dormitory



Asian project of 3 floors, including office, meeting room, dormitory and bathrooms , steel stairs, corridor, bathroom facility are all customized and installed together.

Project-Engineering Camp

Temporary
Airport
office

- 72 sets of container house combined together.



Project-Engineering Camp



Project-Business



This Coffee House has a building area of 200 square meters, It consists of 8 modular box-type rooms. It took only 18 days to complete the installation with interior and exterior decoration. The walls on both sides are made of decoration panels, which are simple and stylish. The use of insulating glass allows the sun to shine into every corner of the room, and the entire building is quietly integrated into nature.

Project-Business

Yansha Shopping Mall



More and more people begin to use container houses as shops, and they can bring us a variety of shapes at random.

Project-Hotel

Hotel

The hotel includes 94 sets of 20ft containers, It takes only 24 days from production to installation.

The modular box houses are designed as hotels or shops in the tourist landscape area. They are not only low in cost, but also mobile. They are easy to dismantle and assemble. Once the tourist season is over, they can be removed at any time. . Compared with the traditional construction method, the integrated box house not only has a short construction period, but also eco friendly and fashionable .



Project-Tourist



Project-School

School In Aruba

The project is located in Aruba and uses modular box houses as private schools with 64 sets of 20ft standard Containers to form 16 classrooms. In just two weeks, a 960-square-meter private elementary school was completed.



Project-School



Project-Office

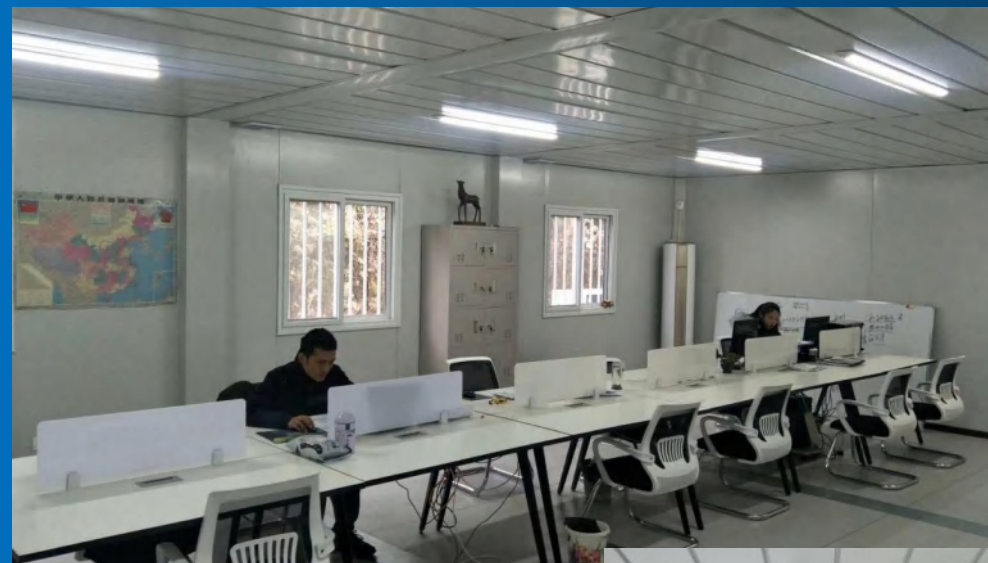

Container office combined together with
container stairs and container walkway

Project-Office



Project- Tea House



Project-Living

Tibet

The project consists of two 3*6M box houses. In order to help the residents improve their housing conditions and support the construction of the western part of China, we use the environmentally-friendly building materials with overall frame structure design, excellent seismic performance, wind resistance and long service life.



During the construction process, no foundation is required. Fireproof sandwich panels are used for the walls, which improve the heat insulation of the house as well. The exterior wall facade can be decorated according to customer's needs.

Project-Living



Function Show-Standard



Founction Show-Office



Three
worker units

Office+
Domitory



Function Show-Meeting Room

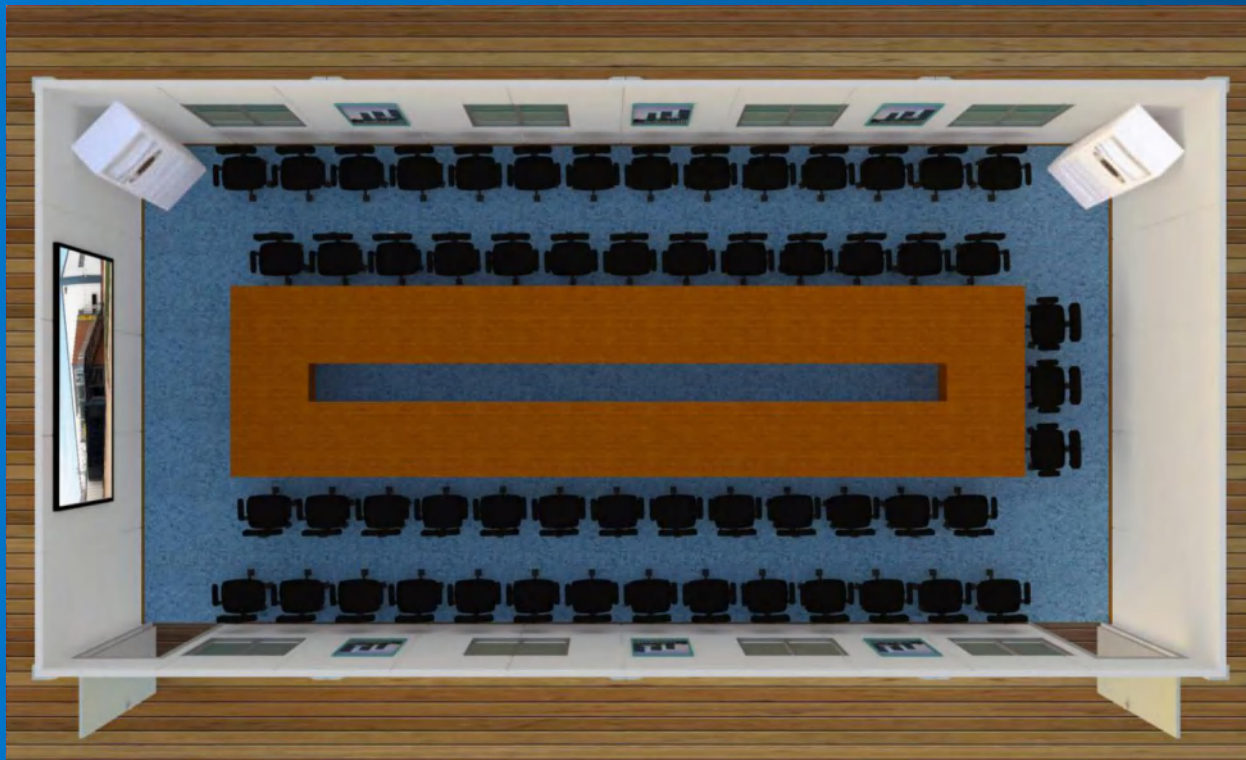

Function Show-Dormitory



Dormitory
Without
Bathroom

Dormitory
With Single
Bathroom



Founction Show-Bathroom



Public

Function Show-Bathroom

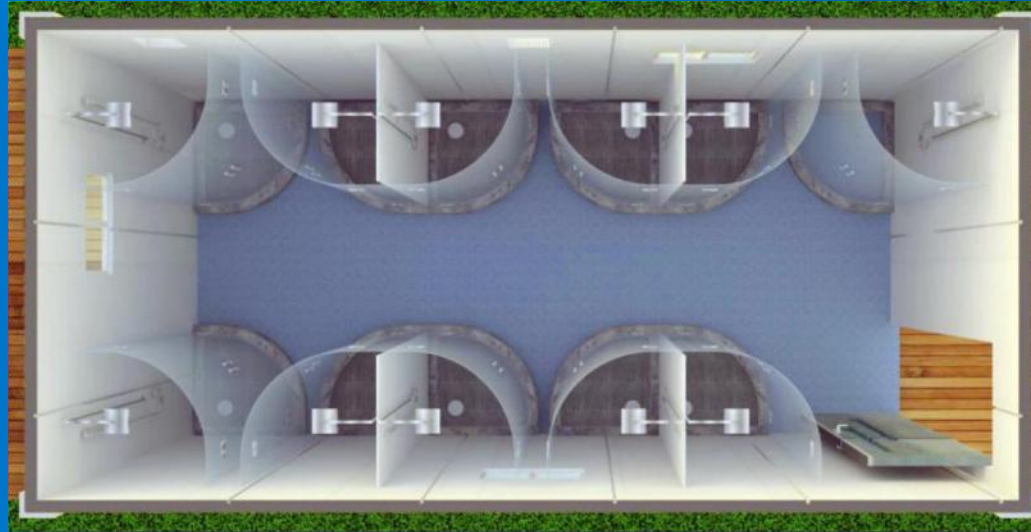

Function Show-Living

One bedroom

Two Bedrooms



Function Show-Living

Three bedrooms





Thank you!